

© 浙江昌一阀门有限公司 版权所有
① 若有改动，恕不另行通知，请用户使用最新版本
② 采用生态纸印刷



浙江昌一阀门有限公司
ZHEJIANG CHANGYI VALVE CO.,LTD

地址：浙江省温州市龙湾区永中街道后章路169号
ADD: No.169, Houzhang Road, Yongzhong Street,
Longwan District, Wenzhou, Zhejiang, China
邮编：325024
电话：0577-86910202
传真：0577-86912020
网址：www.changyivalve.com

昌一阀门有限公司
ZHEJIANG CHANGYI VALVE CO.,LTD



**CHANGYI
VALVE**

浙江昌一阀门有限公司
ZHEJIANG CHANGYI VALVE CO.,LTD

www.changyivalve.com

展望未来

OUTLOOK FUTURE

BUSINESS OUTLOOK
LOOKING TO THE FUTURE



公司简介 COMPANY PROFILE



浙江昌一阀门有限公司是一家集科研、制造、销售于一体不锈钢阀门专业企业 具有丰富的产品设计和加工制造经验及完整的质量控制及售后服务体系。

我公司采用先进的制造工艺 产品可根据不同要求 严格按照中国GB、美国ANSI、德国DIN、日本JIS等标准设计制造。

主要产品有一片式、二片式、三片式螺纹球阀 一片式、二片式、三片式法兰球阀 快速接头、三通T型L型球阀、螺纹及法兰式闸阀截止阀、过滤器、止回阀、高平台球阀、卫生级阀门管件、气动电动阀门、各种精密铸造毛坯及阀门球体等产品。

主要材料根据使用介质、温度不同分别采用 碳钢、不锈钢、低温钢、合金钢、双相钢、耐高温特殊钢等分为手动、蜗轮传动、气动、液动、电动等不同传动方式。

我公司产品广泛用于石油、天然气、化工、钢铁、冶金、供热供暖等等工业重要领域 并出口欧美、东南亚等国家 产品以其可靠性 保用性及优质服务赢得广大用户一致好评。

精湛的制造工艺和不断创新的精神缔造完美商品。先进的检测设备 一丝不苟的检测意识 确保产品的稳定和可靠。我们以专业精神、专业制造、专业服务秉承与客户共同发展 在双赢原则指导下 竭诚欢迎广大客户光临指导 洽谈合作 共创佳绩!

Zhejiang Changyi Valve Co.,Ltd is one professional stainless steel valve manufacturer who incorporates scientific research, manufacturing, trading in an integral whole process. We owned rich product design, experience of producing under the quality control system and after-sales service.

Changyi valve with advanced manufacturing processes to produce, all products were used according to different standard of GB, ANSI, DIN & JIS.

The main products include one, two or three piece thread ball valve, one, two or three piece flange ball valve, quick connectors, T type and L type three-way ball valve, thread and flange type gate valve, globe valve, strainer, check valves, high platform ball valve, sanitary valves, fittings, pneumatic electric valves series, precision casting products, stainless ball and other stainless products. The main material according to the using media, different temperatures were made of carbon steel, stainless steel, low temperature steel, alloy steel, duplex stainless steel, high temperature special steel; separate transmission mode can be selected manual, gear, pneumatic, hydraulic, electric and so on.

Our company products are widely used oil, natural gas, chemical, steel, metallurgy, heating system and so on. It had been exported to Europe, America, Southeast Asia etc. and got good reputation among users due to reliable quality, warranty versatility and good service.

Changyi valve devotes itself entirely to our customers through professional spirit, manufacturing and service. Under the guidance of win-win principle, we sincerely welcome to invite our customers to discuss cooperation and create success.

www.changyivalve.com





2PC美标法兰球阀
2PC ANSI flange ball valve



2PC美标法兰低平台球阀
2PC ANSI low platform flange ball valve



2PC德标法兰球阀
2PC DIN flange ball valve



2PC国标法兰高平台球阀
2PC GB high platform flange valve



2PC日标法兰高平台球阀
2PC JIS high platform flange valve



2PC日标低平台法兰球阀
2PC JIS flange ball valve



美标法兰闸阀
ANSI Flange gate valve



美标截止阀
ANSI Globe valve



美标旋启式止回阀
ANSI swing check valves



3PC德标法兰球阀
3PC DIN flange ball valve



3PC碳钢高压球阀
WCB 3PC high pressure ball valve



3PC高压螺纹球阀
3PC high pressure ball valve



1PC螺纹球阀
1PC thread ball valve



1PC螺纹球阀 (WCB)
1PC thread ball valve (WCB)



2PC经济型球阀
2PC economic type thread ball valve



2PC标准型球阀
2PC standard thread ball valve



2PC德标螺纹球阀
2PC DIN thread ball valve



2PC高压球阀 (2000PSI)
2PC high pressure ball valve(2000PSI)



2PC高平台球阀
2PC High platform ball valve



2PC内外螺纹球阀
2PC FM thread ball valve



3PC螺纹球阀
3PC thread ball valve



3PC对焊球阀
3PC Butt welding ball valve



3PC活对接焊球阀
3PC loose joint butt welding ball valve



3PC高平台螺纹球阀
3PC high platform thread ball valve





3PC高平台对焊球阀
3PC high platform butt welding ball valve



3PC高平台快装球阀
3PC high platform quick ball



3PC碳钢球阀
3PC WCB thread ball valve



3通低平台螺纹球阀
3 Way low platform thread ball valve



3通高平台螺纹球阀
3 Way high platform thread ball valve



高平台薄型球阀
High platform thin type ball valve



Y型螺纹过滤器
Y Type strainer



旋启式止回阀
Swing check valve



对夹止回阀
Wafer check valve



立式止回阀
Vertical check valve



Y型止回阀
Y type check valve



3PC止回阀
3PC check valve





锻钢法兰闸阀
The forged steel flange gate valve



锻钢法兰截止阀
The forged steel flange globe valve



锻钢对焊闸阀
The forged steel Butt-welding gate valve



锻钢对焊截止阀
The forged steel Butt-welding globe valve



锻钢内螺纹、承插焊闸阀
The forged steel NPT(S.W) gate valve



锻钢内螺纹、承插焊截止阀
The forged steel NPT(S.W) globe valve



锻钢法兰止回阀
The forged steel flange check valve



锻钢内螺纹、承插焊升降式止回阀
The forged steel NPT(S.W) lift check valve



锻钢内螺纹、承插焊旋启式止回阀
The forged steel NPT(S.W) swing check valve



S型螺纹截止阀 (WCB)
S Type Thread Globe valve(WCB)



螺纹截止阀
Thread Globe valve



螺纹闸阀
Thread gate valve



2PC气动法兰球阀 (国标)
2PC Pneumatic flange ball valve(GB)



2PC低平台气动球阀
2PC low platform pneumatic ball valve



2PC气动法兰球阀 (德标)
2PC Pneumatic flange ball valve(DIN)



3PC气动球阀
3PC Pneumatic ball valve



气动三通快装球阀
Pneumatic tee ball valve



2PC气动快装球阀
2PC Pneumatic ball valve

CONTENTS

目录

- | | | | |
|----|--|----|--|
| 01 | 2PC美标法兰高平台球阀CL150
2PC ANSI high platform flange valve CL150 | 20 | 3PC碳钢球阀
3PC WCB thread ball valve |
| 02 | 2PC美标法兰低平台球阀CL150
2PC ANSI low platform flange ball valve CL150 | 21 | 3PC德标法兰高平台球阀PN40
3PC DIN high platform flange valve PN40 |
| 03 | 2PC德标法兰高平台球阀PN16
2PC DIN high platform flange valve PN16 | 22 | 三通高平台内螺纹球阀
3 way High platform of thread ball valve |
| 04 | 2PC日标法兰高平台球阀10K
2PC JIS high platform flange valve10K | 23 | 内螺纹闸阀
Thread gate valve |
| 05 | 2PC国标法兰高平台球阀PN16
2PC GB high platform flange valve PN16 | 24 | 内螺纹截止阀
Thread globe valve |
| 06 | 3PC碳钢高压球阀
WCB 3PC high pressure ball valve | 25 | Y型过滤器
Y Type Strainer |
| 07 | 美标法兰闸阀CL150
ANSI Flange Gate valve CL150 | 26 | 旋启式内螺纹止回阀
Swing thread check valve |
| 08 | 美标截止阀
ANSI Globe valve | 27 | 对夹止回阀PN25
Wafer check valve PN25 |
| 09 | 美标旋启式止回阀
ANSI swing check valves | 28 | Y型止回阀
Y type check valve |
| 10 | 1PC带锁内螺纹球阀
1PC locking thread ball valve | 29 | 3PC止回阀
3PC check valve |
| 11 | 1PC内螺纹球阀
1PC thread ball valve | 30 | CL150~600/10~40K锻钢法兰闸阀
The forged steel flange gate valve |
| 12 | 1PC碳钢球阀带锁
WCB 1PC thread ball valve | 31 | CL150~600锻钢对焊闸阀
The forged steel Butt-welding gate valve |
| 13 | 2PC 2000PSI内螺纹球阀
2PC 2000PSI thread ball valve | 32 | CL150~800锻钢内螺纹、承插焊闸阀
The forged steel NPT(S.W) gate valve |
| 14 | 2PC经济型内螺纹球阀
2PC economic type thread ball valve | 33 | CL150~600/10~40K锻钢法兰截止阀
The forged steel flange globe valve |
| 15 | 2PC标准型内螺纹球阀
2PC standard thread ball valve | 34 | CL150~600锻钢对焊截止阀
The forged steel Butt-welding globe valve |
| 16 | 2PC德标内螺纹球阀
2PC DIN thread ball valve | 35 | CL150~800锻钢内螺纹、承插焊截止阀
The forged steel NPT(S.W) globe valve |
| 17 | 2PC内外螺纹球阀
2PC FM thread ball valve | 36 | CL150~600锻钢法兰止回阀
The forged steel flange check valve |
| 18 | 3PC德标高平台内螺纹球阀
3PC DIN High Platform thread ball valve | 37 | CL150~800锻钢内螺纹、承插焊升降式止回阀
The forged steel NPT(S.W) lift check valve |
| 19 | 3PC德标内螺纹球阀
3PC DIN thread ball valve | 38 | CL800~1500锻钢内螺纹、承插焊旋启式止回阀
The forged steel NPT(S.W) swing check valve |

2PC美标法兰高平台球阀CL150
2PC ANSI high platform flange valve CL150

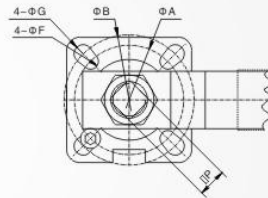
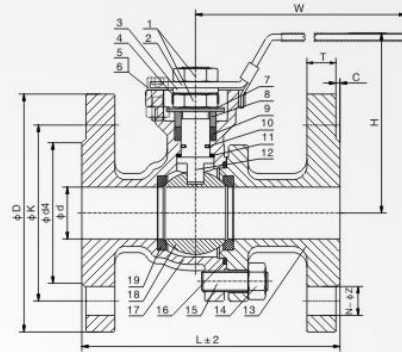

标准规范 Applicable Standards	
设计制造 Design	API608
平台 Actuated Connecting	ISO5211
结构长度 FACE to FACE	ASME B16.10
连接法兰 End Flange	ASME B16.5
试验 Testing	API598

序号NO.	零件名称PART NAME	材料MATERIAL
1	螺母 Nut	304/316
2	手柄 Handle	304/316
3	垫片 Washer	304/316
4	防松盖 Anti Loosing Cap	304/316
5	内六角螺钉 Hex Screws	304/316
6	螺母 Nut	304/316
7	碟形弹簧 Disc Spring	304/316
8	填料压盖 Gland	304/316
9	填料 Packing	PTFE
10	O型圈 O-Rings	Viton
11	止推垫片 Thrust Gasket	PTFE
12	阀杆 Stem	304/316
13	阀盖 Bonnet	CF8/CF8M
14	螺母 Nut	304/316
15	双头螺栓 Stud Bolt	304/316
16	密封垫 Gasket	PTFE
17	阀体 Body	CF8/CF8M
18	球体 Ball	304/316
19	阀座 Seat	PTFE

	1/2"	3/4"	1"	1 1/4"	1 1/2"	2"	2 1/2"	3"	4"
d	15	20	25	32	38	49	65	80	100
L	108	117	127	140	165	178	190	203	229
T	9	9.3	9.8	11.2	12.7	14.3	15.8	17.3	17.6
C	2	2	2	2	2	2	2	2	2
D	90	100	108	115	125	150	178	188	228
K	60.3	69.9	79.4	88.9	98.4	120.7	139.7	152.4	190.5
d4	34	42	50	62	71.5	91	103	125	155
N-Z	4-16	4-16	4-16	4-16	4-16	4-19	4-19	4-19	8-19
H	75	80	90	100	120	130	150	160	185
W	125	125	155	155	185	185	260	260	300
ISO5211	A	36	36	42	42	50	50	70	70
	B	42	42	50	50	70	70	102	102
	F	5.5	5.5	6	6	7	7	9	9
	G	6	6	7	7	9	9	11	11
	P	9	9	11	11	14	14	17	17
重量Weight									

2PC美标法兰低平台球阀CL150
2PC ANSI low platform flange ball valve CL150

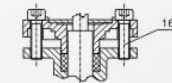
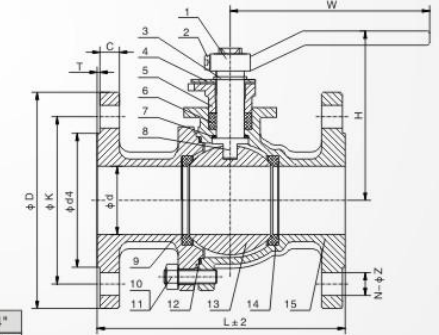

标准规范 Applicable Standards	
设计制造 Design	API608
结构长度 FACE to FACE	ASME B16.10
连接法兰 End Flange	ASME B16.5
试验 Testing	API598

序号NO.	零件名称PART NAME	材料MATERIAL
1	手柄 Handle	304/316
2	内六角螺钉 Hex Screws	304/316
3	卡簧 Jump Ring	304/316
4	定位片 Orientation patch	304/316
5	填料压盖 Gland	304/316
6	填料 Packing	PTFE
7	止推垫片 Thrust Gasket	PTTF
8	阀杆 Stem	304/316
9	阀盖 Bonnet	CF8/CF8M
10	螺母 Nut	304/316
11	双头螺栓 Stud Bolt	304/316
12	密封垫 Gasket	PTFE
13	球体 Ball	304/316
14	阀座 Seat	PTFE
15	阀体 Body	CF8/CF8M
16	内六角螺钉 Hex Screws	304/316

	1/2"	3/4"	1"	1 1/4"	1 1/2"	2"	2 1/2"	3"	4"
d	15	20	25	32	38	49	65	80	100
L	108	117	127	140	165	178	190	203	229
T	8	9.5	10	11	12.5	14	16	17	20.5
C	2	2	2	2	2	2	2	2	2
D	89	98	108	116	127	152	178	190	229
K	60.3	69.9	79.4	88.9	98.4	120.7	139.7	152.4	190.5
d4	34.9	42.9	50.8	63.5	73	92.1	104.8	127	153
N-Z	4-16	4-16	4-16	4-16	4-16	4-19	4-19	4-19	8-19
H	75	80	85	100	120	130	145	160	185
W	150	150	150	170	230	230	230	310	310
重量Weight									

2PC德标法兰高平台球阀PN16
2PC DIN high platform flange valve PN16

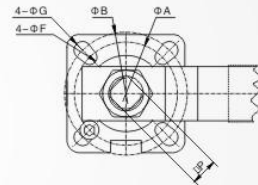
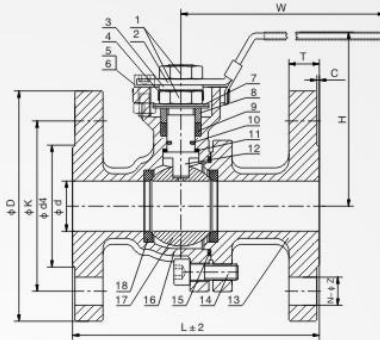
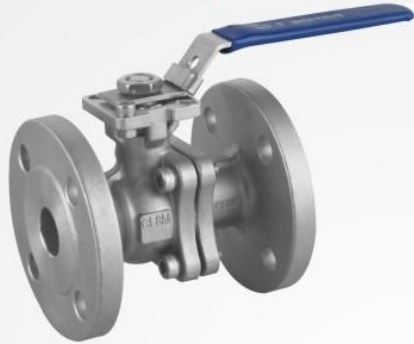

标准规范 Applicable Standards	
设计制造 Design	DIN3357
平台 Actuated Connecting	ISO5211
结构长度 FACE to FACE	DIN3202-F4
连接法兰 End Flange	DIN2633/EN1092-1
试验 Testing	DIN3230/EN12266

	1/2"	3/4"	1"	1 1/4"	1 1/2"	2"	2 1/2"	3"	4"
d	15	20	25	32	38	49	65	80	100
L	115	120	125	130	140	150	170	180	190
T	14	16	16	16	16	18	18	20	20
C	2	2	2	2	2	2	2	2	2
D	95	105	115	140	150	165	185	200	220
K	65	75	85	100	110	125	145	160	180
d4	45	58	68	78	88	102	122	138	158
N-Z	4-14	4-14	4-14	4-18	4-18	4-18	4-18	8-18	8-18
H	75	80	90	100	120	130	150	160	185
W	125	125	155	155	185	185	260	260	300
ISO5211	A	36	36	42	42	50	50	70	70
	B	42	42	50	50	70	70	102	102
	F	5.5	5.5	6	6	7	7	9	9
	G	6	6	7	7	9	9	11	11
	P	9	9	11	11	14	14	17	17
重量Weight									

序号NO.	零件名称PART NAME	材料MATERIAL
1	螺母 Nut	304/316
2	手柄 Handle	304/316
3	垫片 Washer	304/316
4	防松盖 Anti Loosing Cap	304/316
5	内六角螺钉 Hex Screws	304/316
6	螺母 Nut	304/316
7	碟形弹簧 Disc Spring	304/316
8	填料压盖 Gland	304/316
9	填料 Packing	PTFE
10	O型圈 O-Rings	Viton
11	止推垫片 Thrust Gasket	PTFE
12	阀杆 Stem	304/316
13	阀盖 Bonnet	CF8/CF8M
14	内六角螺钉 Hex Screws	304/316
15	密封垫 Gasket	PTFE
16	阀体 Body	CF8/CF8M
17	球体 Ball	304/316
18	阀座 Seat	PTFE

2PC日标法兰高平台球阀10K
2PC JIS high platform flange valve 10K

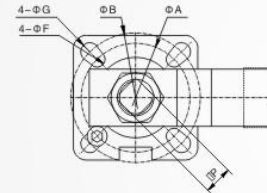
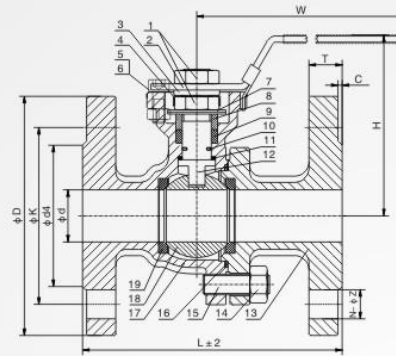

标准规范 Applicable Standards	
设计制造 Design	JIS B2002
平台 Actuated Connecting	ISO5211
结构长度 FACE to FACE	JIS B2002
连接法兰 End Flange	JIS B2220
试验 Testing	JIS B2003

	1/2"	3/4"	1"	1 1/4"	1 1/2"	2"	2 1/2"	3"	4"
d	15	20	25	32	38	49	65	80	100
L	108	117	127	140	165	178	190	203	229
T	12	14	14	16	16	16	18	18	18
C	1	1	1	2	2	2	2	2	2
D	95	100	125	135	140	155	175	185	210
K	70	75	90	100	105	120	140	150	175
d4	51	56	67	76	81	96	116	126	151
N-Z	4-15	4-15	4-19	4-19	4-19	4-19	4-19	8-19	8-19
H	75	80	95	100	120	130	150	160	185
W	125	125	155	155	185	185	260	260	300
ISO5211	A	36	36	42	42	50	50	70	70
	B	42	42	50	50	70	70	102	102
	F	5.5	5.5	6	6	7	7	9	9
	G	6	6	7	7	9	9	11	11
	P	9	9	11	11	14	14	17	17
重量Weight									

序号NO.	零件名称PART NAME	材料MATERIAL
1	螺母 Nut	304/316
2	手柄 Handle	304/316
3	垫片 Washer	304/316
4	防松盖 Anti Loosing Cap	304/316
5	内六角螺钉 Hex Screws	304/316
6	螺母 Nut	304/316
7	碟形弹簧 Disc Spring	304/316
8	填料压盖 Gland	304/316
9	填料 Packing	PTFE
10	O型圈 O-Rings	Viton
11	止推垫片 Thrust Gasket	PTFE
12	阀杆 Stem	304/316
13	阀盖 Bonnet	CF8/CF8M
14	螺母 Nut	304/316
15	双头螺栓 Stud Bolt	304/316
16	密封垫 Gasket	PTFE
17	阀体 Body	CF8/CF8M
18	球体 Ball	304/316
19	阀座 Seat	PTFE

2PC国标法兰高平台球阀PN16
2PC GB high platform flange valve PN16

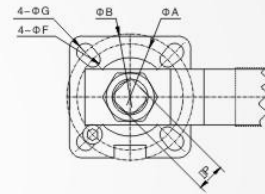
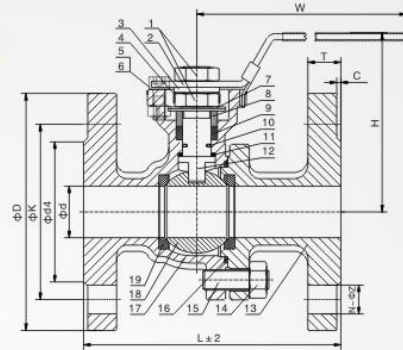

标准规范 Applicable Standards	
设计制造 Design	GB12237
平台 Actuated Connecting	ISO5211
结构长度 FACE to FACE	GB12221
连接法兰 End Flange	JB79.1
试验 Testing	JB9092

	1/2"	3/4"	1"	1 1/4"	1 1/2"	2"	2 1/2"	3"	4"
d	15	20	25	32	38	49	65	80	100
L	130	140	150	165	180	200	220	250	280
T	14	14	14	16	16	16	18	20	20
C	2	2	2	2	2	2	3	3	3
D	95	105	115	135	145	160	180	195	215
K	65	75	85	100	110	125	145	160	180
d4	45	55	65	78	85	100	120	135	155
N-Z	4-14	4-14	4-14	4-18	4-18	4-18	8-18	8-18	8-18
H	75	80	90	100	120	130	150	160	185
W	125	125	155	155	185	185	260	260	300
ISO5211	A	36	36	42	42	50	50	70	70
	B	42	42	50	50	70	70	102	102
	F	5.5	5.5	6	6	7	7	9	9
	G	6	6	7	7	9	9	11	11
	P	9	9	11	11	14	14	17	17
重量Weight									

序号NO.	零件名称 PART NAME	材料 MATERIAL
1	螺母 Nut	304/316
2	手柄 Handle	304/316
3	垫片 Washer	304/316
4	防松盖 Anti Loosing Cap	304/316
5	内六角螺钉 Hex Screws	304/316
6	螺母 Nut	304/316
7	碟形弹簧 Disc Spring	304/316
8	填料压盖 Gland	304/316
9	填料 Packing	PTFE
10	O型圈 O-Rings	Viton
11	止推垫片 Thrust Gasket	PTFE
12	阀杆 Stem	304/316
13	阀盖 Bonnet	CF8/CF8M
14	螺母 Nut	304/316
15	双头螺栓 Stud Bolt	304/316
16	密封垫 Gasket	PTFE
17	阀体 Body	CF8/CF8M
18	球体 Ball	304/316
19	阀座 Seat	PTFE

3PC碳钢高压球阀
WCB 3PC high pressure ball valve



标准规范 Applicable Standards	
设计制造 Design	GB12224
结构长度 FACE to FACE	GB12221
连接螺纹 End Threaded	ISO7/1
试验 Testing	JB9092

序号NO.	零件名称 PART NAME	材料 MATERIAL
1	螺母 Nut	304/316
2	手柄 Handle	304/316
3	碟形弹簧 Disc Spring	304/316
4	填料压盖 Gland	304/316
5	填料 Packing	PTFE
6	止推垫片 Thrust Gasket	PTFE
7	阀杆 Stem	304/316
8	球体 Ball	304/316
9	阀座 Seat	PTFE
10	内六角螺钉 Hex Screws	304/316
11	阀盖 Bonnet	CF8/CF8M
12	阀体 Body	CF8/CF8M

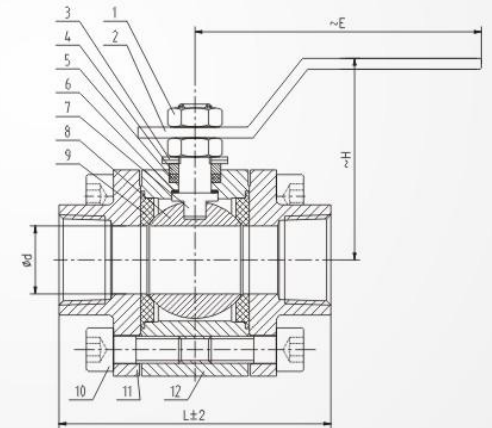

	1/4"	3/8"	1/2"	3/4"	1"	1 1/4"	1 1/2"	2"
d	8	10	12	15	20	25	32	38
L	66	66	66	72	96	108	118	128
H	42	42	42	44	61	64	77	81
W	110	110	110	150	150	180	180	190
重量Weight								

美标法兰闸阀CL150
ANSI Flange Gate valve CL150



标准规范 Applicable Standards	
设计制造 Design	ASME B16.34
结构长度 FACE to FACE	ASME B16.10
连接法兰 End Flange	ASME B16.5
试验 Testing	API598

序号NO.	零件名称PART NAME	材料MATERIAL
1	阀体 Body	WCB
2	阀座 Seat	WCB+13Cr
3	闸板 Wedge	WCB+13Cr
4	阀杆 Stem	F6a
5	密封垫 Gasket	304+Graphite
6	上密封 Back Face	WCB+13Cr
7	阀盖 Bonnet	WCB
8	填料 Packing	Graphite
9	销轴 Pin	CS
10	开口销 Split Cotter	CS
11	压盖 Gland Flange	WCB
12	活节螺栓 Eye Bolt	B7
13	螺母 Nut	2H
14	弹垫 Spring Washer	CS
15	阀杆螺母 Stem Nut	Ductile Iron
16	压盖螺母 Gland Nut	CS
17	手轮 Hand Wheel	Malleable Iron
18	垫片 Washer	CS
19	锁紧螺母 Lock Nut	CS
20	双头螺栓 Stud Bolt	B7
21	螺母 Nut	2H

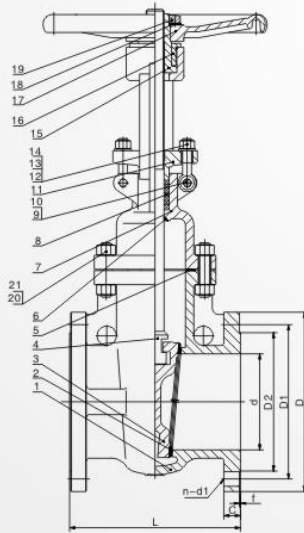

NPS	d	L	D2	D1	D	C	f	n-d1	重量Weight
18"	438	432	533.4	577.9	635	40	1.6	16-φ32	
16"	387	406	469.9	539.8	595	37	1.6	16-φ29	
14"	336	381	412.8	476.3	535	35.5	1.6	12-φ29	
12"	300	356	381	431.8	485	32	1.6	12-φ25	
10"	250	330	323.8	362	405	30.5	1.6	12-φ25	
8"	200	292	269.9	298.5	345	28.5	1.6	8-φ22	
6"	150	267	215.9	241.3	280	25.5	1.6	8-φ22	
4"	100	229	157.2	190.5	230	24	1.6	8-φ19	
3"	76	203	127	152.4	190	19	1.6	4-φ19	
2"	50	178	92	120.7	150	16	2	4-φ19	

美标截止阀
ANSI Globe valve



型号 Type	Mpa	PSI
强度试验 Shell test	3.0	450
高压密封试验(水) Sealing test(Water)	2.2	314
低压密封试验(空气) Sealing test(Air)	5~7 巴 Bar	

材质名称 Name of material	适用温度 Working temperature	适用介质 SuitableMedium
CF8	≤200°C	NITRIC ACID
0Cr18Ni9		硝酸类
CF8M		NITRIC ACID
0Cr18Ni12Mo2Ti		硝酸类
CF3		NITRIC ACID
00Cr18Ni10		硝酸类
CF3M		NITRIC ACID
00Cr17Ni14Mo2		硝酸类

公称口径 NPS Nomina Diameter	IN	MM	单位压力级 unitary pressure grade	L	D	D ₁	D ₂	H	B	N-φd	D ₀
		10-k	108	95	70	52	169	12	4-15	125	
		150Lb	117	98	70	43	180	12	4-15	125	
		10-k	117	100	75	58	180	14	4-15	125	
		150Lb	127	108	79.5	51	190	12	4-15	125	
		10-k	127	125	90	70	190	14	4-19	125	
		150Lb	165	127	98.5	73	347	14.3	4-16	180	
		10-k	165	140	105	85	347	16	1-19	180	
		150Lb	203	152	120	100	356	16	4-19	180	
		10-k	203	155	120	100	356	16	4-19	180	
		150Lb	216	178	139.5	105	381	17.5	4-19	240	
		10-k	216	175	140	120	381	18	4-19	240	
		150Lb	241	190	152.5	127	413	19.1	4-19	280	
		10-k	241	185	150	130	413	18	8-19	280	
		150Lb	292	229	190.5	157	500	23.9	8-19	280	
		10-k	292	210	175	155	500	18	8-19	280	
		150Lb	406	279	241.5	216	656	25.4	8-22	360	
		10-k	406	280	240	215	656	22	8-23	360	
		150Lb	495	343	298.5	270	660	28.5	8-22	450	
		10-k	495	330	290	265	660	22	8-23	450	

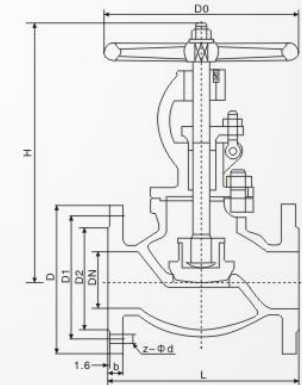

美标旋启式止回阀
ANSI swing check valves



试验压力 Test Pressure	公称压力Nominal Pressure(Lb)			
	150	300	400	
壳体强度试验 Shell strength test	3.1	7.8	10.3	
密封试验 Seal test	2.2	5.6	7.6	
阀体材料 Material of valve	WCB(C)	CF8(P)	CF8M(R)	6WC9(V)
工作温度(°C) Working Temperature	≤425	≤100	≤100	≤540
适用介质 Applicable medium	水、蒸汽、油品 Water, steam, oil	硝酸类 Nitric acid	醋酸类 Acetic acid	水、蒸汽 Water, steam

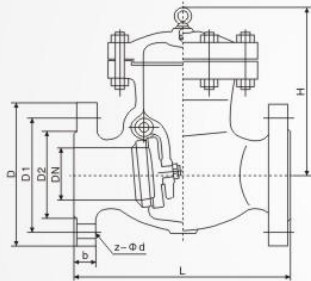

公称口径 NPS Nominal Diameter		单位 Unit	主要外形尺寸和连接尺寸(mm) Dimensions						
IN	MM		L	D	D ₁	D ₂	H	Z-Ød	D ₀
2"	50	in	9.00	6.00	4.75	3.62	0.75	4-0.75	6.34
		mm	203	157	120.7	92	19.5	4-19	161
2 1/2"	65	in	8.50	7.00	5.50	4.12	0.88	4-0.75	7.08
		mm	216	178	139.7	105	22.5	4-19	180
3"	80	in	9.50	7.50	6.00	5.00	0.94	4-0.75	7.48
		mm	241	190.5	152.4	127	24	1-19	190
4"	100	in	11.50	9.00	7.50	6.19	0.94	8-0.75	8.66
		mm	292	229	190.5	157.2	24	8-19	220
6"	150	in	14.00	11.00	9.50	8.50	1.00	4-0.88	10.12
		mm	356	279	241.5	216	25.5	8-22.5	257
8"	200	in	19.50	13.50	11.75	10.62	1.12	8-0.88	11.50
		mm	495	343	298.5	270	29	8-22.5	292
10"	250	mm	24.5	16.00	14.25	12.75	1.19	12-1.00	13.78
		in	622	406	362	324	30.5	12-25	350
12"	300	in	27.50	19.00	17.00	15.00	1.25	12-1.00	15.60
		mm	699	483	432	381	32	12-25	38

1PC带锁内螺纹球阀
1PC locking thread ball valve



标准规范 Applicable Standards	
设计制造 Design	GB12237
结构长度 FACE to FACE	GB12221
连接螺纹 End Threaded	ISO7/1
试验 Testing	JB9092

序号NO.	零件名称PART NAME	材料MATERIAL
1	螺母 Nut	304/316
2	弹垫 Spring Washer	304/316
3	手柄 Handle	304/316
4	填料压盖 Gland Nut	304/316
5	填料 Packing	PTFE
6	止推垫片 Thrust Gasket	PTFE
7	阀杆 Stem	304/316
8	上阀座 On Seat	PTFE
9	阀体 Body	CF8/CF8M
10	并帽 Lock Nut	304/316
11	垫片 Washer	304/316
12	球体 Ball	304/316
13	下阀座 Next Seat	PTFE

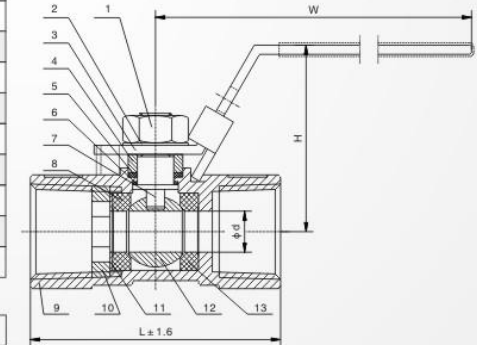

	1/2"	3/4"	1"	1 1/4"	1 1/2"	2"
d	9	12	15	20	25	32
L	54	59	71	78	84	101
H	40	40	45	55	55	65
W	95	100	115	125	125	140
重量Weight						

1PC内螺纹球阀
1PC thread ball valve



标准规范 Applicable Standards	
设计制造 Design	GB12237
结构长度 FACE to FACE	GB12221
连接螺纹 End Threaded	ISO7/1
试验 Testing	JB9092

序号NO.	零件名称PART NAME	材料MATERIAL
1	螺母 Nut	304/316
2	弹垫 Spring Washer	304/316
3	手柄 Handle	304/316
4	填料压盖 Gland Nut	304/316
5	填料 Packing	PTFE
6	止推垫片 Thrust Gasket	PTFE
7	阀杆 Stem	304/316
8	上阀座 On Seat	PTFE
9	阀体 Body	CF8/CF8M
10	并帽 Lock Nut	304/316
11	垫片 Washer	304/316
12	球体 Ball	304/316
13	下阀座 Next Seat	PTFE

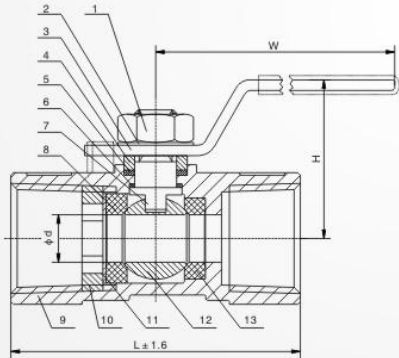

	1/2"	3/4"	1"	1 1/4"	1 1/2"	2"
d	9	12	15	20	25	32
L	40	58	67	76	81	96
H	40	40	45	55	55	65
W	95	100	115	125	125	140
重量Weight						

1PC碳钢球阀带锁
WCB 1PC thread ball valve



标准规范 Applicable Standards	
设计制造 Design	GB12237
结构长度 FACE to FACE	GB12221
连接螺纹 End Threaded	ISO7/1
试验 Testing	JB9092

序号NO.	零件名称 PART NAME	材料 MATERIAL
1	螺母 Nut	304/316
2	弹垫 Spring Washer	304/316
3	手柄 Handle	304/316
4	填料压盖 Gland Nut	304/316
5	填料 Packing	PTFE
6	止推垫片 Thrust Gasket	PTFE
7	阀杆 Stem	304/316
8	上阀座 On Seat	PTFE
9	阀体 Body	WCB/CF8/CF8M
10	并帽 Lock Nut	304/316
11	垫片 Washer	304/316
12	球体 Ball	304/316
13	下阀座 Next Seat	PTFE

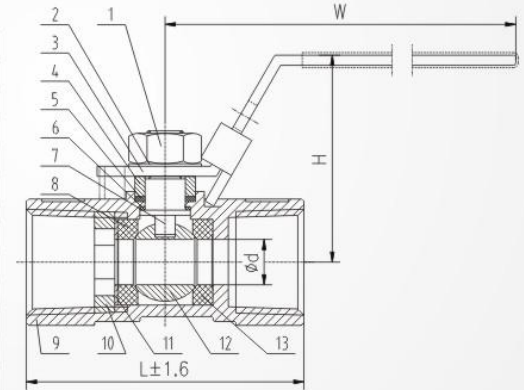

	1/4"	3/8"	1/2"	3/4"	1"	1 1/4"	1 1/2"	2"	2 1/2"	3"	4"
d	5	7	9	12	15	20	25	32	38	50	65
L	40	44	54	59	71	78	84	101	110	133	185
H	32	32	40	40	45	55	55	65	95	100	130
W	72	72	95	100	115	125	125	140	175	175	235
重量Weight											

2PC 2000PSI内螺纹球阀
2PC 2000PSI thread ball valve



标准规范 Applicable Standards	
设计制造 Design	API608
结构长度 FACE to FACE	ASME-B16.10
连接螺纹 End Threaded	NPT
试验 Testing	API598

序号NO.	零件名称PART NAME	材料MATERIAL
1	螺母 Nut	304/316
2	弹垫 Spring Washer	304/316
3	阀杆 Stem	304/316
4	手柄 Handle	304/316
5	填料压盖 Gland Nut	304/316
6	填料 Packing	PTFE
7	止推垫片 Thrust Gasket	PTFE
8	阀盖 Bonnet	CF8/CF8M
9	密封垫 Gasket	PTFE
10	阀座 Seat	PTFE
11	球体 Ball	304/316
12	阀体 Body	CF8/CF8M

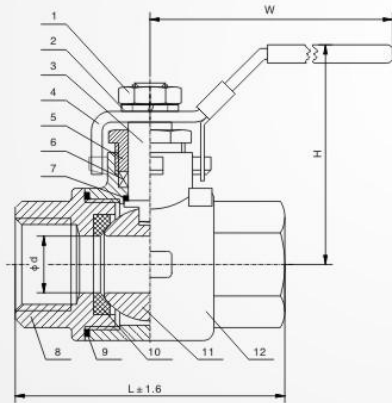

d	1/4"	3/8"	1/2"	3/4"	1"	1 1/4"	1 1/2"	2"
d	8	10	15	20	25	32	38	49
L	55	55	63	73	84	93	111	123
H	45	45	55	60	65	80	90	95
W	100	100	110	120	130	150	160	180
重量Weight								

2PC经济型内螺纹球阀
2PC economic type thread ball valve



标准规范 Applicable Standards	
设计制造 Design	GB12237
结构长度 FACE to FACE	GB12221
连接螺纹 End Threaded	ISO7/1
试验 Testing	JB9092

序号NO.	零件名称PART NAME	材料MATERIAL
1	螺母 Nut	304/316
2	弹垫 Spring Washer	304/316
3	阀杆 Stem	304/316
4	手柄 Handle	304/316
5	填料压盖 Gland Nut	304/316
6	填料 Packing	PTFE
7	止推垫片 Thrust Gasket	PTFE
8	阀盖 Bonnet	CF8/CF8M
9	密封垫 Gasket	PTFE
10	阀座 Seat	PTFE
11	球体 Ball	304/316
12	阀体 Body	CF8/CF8M

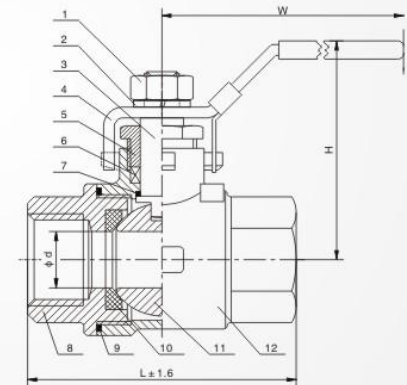

d	1/2"	3/4"	1"	1 1/4"	1 1/2"	2"	2 1/2"	3"	4"
d	15	20	25	32	38	49	65	80	100
L	55	65	72	83	95	110	144	170	202
H	55	60	70	75	90	100	130	140	165
W	105	115	120	145	175	175	210	230	300
重量Weight									

2PC标准型内螺纹球阀
2PC standard thread ball valve



标准规范 Applicable Standards	
设计制造 Design	GB12237
结构长度 FACE to FACE	GB12221
连接螺纹 End Threaded	ISO7/1
试验 Testing	JB9092

序号NO.	零件名称PART NAME	材料MATERIAL
1	螺母 Nut	304/316
2	弹垫 Spring Washer	304/316
3	阀杆 Stem	304/316
4	手柄 Handle	304/316
5	填料压盖 Gland Nut	304/316
6	填料 Packing	PTFE
7	止推垫片 Thrust Gasket	PTFE
8	阀盖 Bonnet	CF8/CF8M
9	密封垫 Gasket	PTFE
10	阀座 Seat	PTFE
11	球体 Ball	304/316
12	阀体 Body	CF8/CF8M

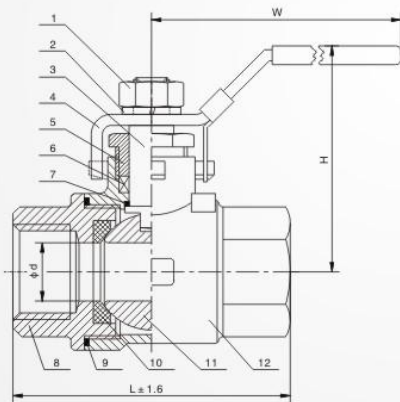

	1/4"	3/8"	1/2"	3/4"	1"	1 1/4"	1 1/2"	2"
d	12	12	15	20	25	32	38	49
L	52	52	60	72	83	96	103	123
H	55	55	55	60	70	75	90	100
W	90	90	105	115	120	145	175	175
重量Weight								

2PC德标内螺纹球阀
2PC DIN thread ball valve



标准规范 Applicable Standards	
设计制造 Design	DIN3357
结构长度 FACE to FACE	DIN3202-M3
连接螺纹 End Threaded	DIN259/DIN2999
试验 Testing	DIN3230/EN12266

序号NO.	零件名称PART NAME	材料MATERIAL
1	螺母 Nut	304/316
2	弹垫 Spring Washer	304/316
3	阀杆 Stem	304/316
4	手柄 Handle	304/316
5	填料压盖 Gland Nut	304/316
6	填料 Packing	PTFE
7	止推垫片 Thrust Gasket	PTFE
8	阀盖 Bonnet	CF8/CF8M
9	密封垫 Gasket	PTFE
10	阀座 Seat	PTFE
11	球体 Ball	304/316
12	阀体 Body	CF8/CF8M

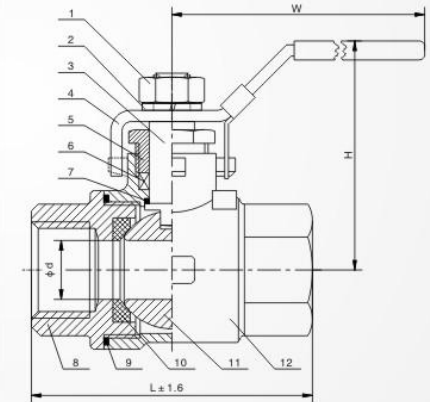

	1/4"	3/8"	1/2"	3/4"	1"	1 1/4"	1 1/2"	2"	2 1/2"	3"	4"
d	12	12	15	20	25	32	38	49	65	80	100
L	50	60	75	80	90	110	120	140	185	205	240
H	55	55	55	60	70	75	90	100	130	140	165
W	90	90	105	115	120	145	175	175	210	230	300
重量Weight											

2PC内外螺纹球阀
2PC FM thread ball valve



标准规范 Applicable Standards	
设计制造 Design	GB12237
结构长度 FACE to FACE	GB12221
连接螺纹 End Threaded	ISO7/1
试验 Testing	JB9092

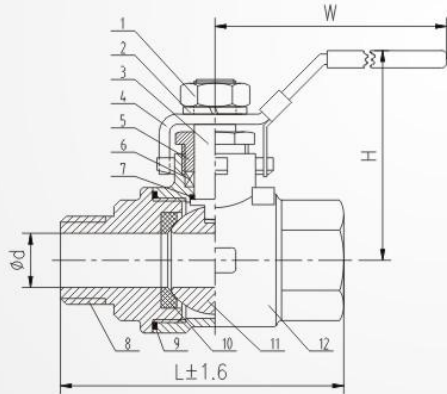

序号NO.	零件名称 PART NAME	材料 MATERIAL
1	螺母 Nut	304/316
2	弹垫 Spring Washer	304/316
3	阀杆 Stem	304/316
4	手柄 Handle	304/316
5	填料压盖 Gland	304/316
6	填料 Packing	PTFE
7	止推垫片 Thrust Gasket	PTFE
8	阀盖 Bonnet	WCB/CF8/CF8M
9	密封垫 Gasket	PTFE
10	阀座 Seat	PTFE
11	球体 Ball	304/316
12	阀体 Body	WCB/CF8/CF8M

	1/4"	3/8"	1/2"	3/4"	1"	1 1/4"	1 1/2"	2"
d	8	10	15	20	25	32	38	49
L	58	58	66	78	84	98	110	125
H	55	55	55	60	70	75	90	100
W	90	90	105	115	120	145	175	175
重量Weight								

3PC德标高平台内螺纹球阀
3PC DIN High Platform thread ball valve



标准规范 Applicable Standards	
设计制造 Design	DIN3357
平台 Actuated Connecting	ISO5211
结构长度 FACE to FACE	DIN3202-M3
连接螺纹 End Threaded	DIN259/DIN2999
试验 Testing	DIN3230/EN12266

序号NO.	零件名称PART NAME	材料MATERIAL
1	螺母 Nut	304/316
2	手柄 Handle	304/316
3	垫片 Washer	304/316
4	防松盖Anti Loosing Cap	304/316
5	内六角螺钉 Hex Screws	304/316
6	螺母 Nut	304/316
7	碟形弹簧 Disc Spring	304/316
8	填料压盖 Gland	304/316
9	填料 Packing	PTFE
10	O型圈 O-Rings	Viton
11	止推垫片Thrust Gasket	PTFE
12	阀杆 Stem	304/316
13	球体 Ball	304/316
14	弹垫 Spring Washer	304/316
15	螺母 Nut	304/316
16	阀盖 Bonnet	CF8/CF8M
17	阀体 Body	CF8/CF8M
18	阀座 Seat	PTFE
19	螺栓 Bolt	304/316

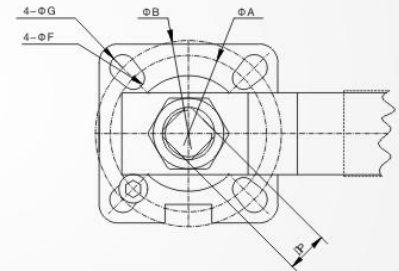
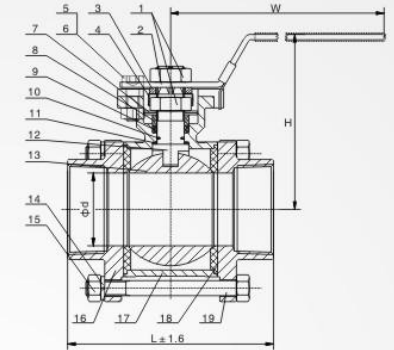

	1/2"	3/4"	1"	1 1/4"	1 1/2"	2"
d	15	20	25	32	38	49
L	75	80	90	110	140	150
H	70	70	85	90	110	125
W	125	125	155	155	185	185
ISO5211	A	36	36	42	42	50
	B	42	42	50	50	70
	F	5.5	5.5	6	6	7
	G	6	6	7	7	9
	P	9	9	11	11	14
重量Weight						

3PC德标内螺纹球阀
3PC DIN thread ball valve



标准规范 Applicable Standards	
设计制造 Design	DIN3357
结构长度 FACE to FACE	DIN3202-M3
连接螺纹 End Threaded	DIN259/DIN2999
试验 Testing	DIN3230/EN12266

序号NO.	零件名称PART NAME	材料MATERIAL
1	螺母 Nut	304/316
2	弹垫 Spring Washer	304/316
3	手柄 Handle	304/316
4	填料压盖 Gland	304/316
5	填料 Packing	PTFE
6	止推垫片 Thrust Gasket	PTFE
7	阀杆 Stem	304/316
8	螺母 Nut	304/316
9	螺栓 Bolt	304/316
10	弹垫 Spring Washer	304/316
11	阀盖 Bonnet	CF8/CF8M
12	阀座 Seat	PTFE
13	阀体 Body	CF8/CF8M
14	球体 Ball	304/316

	1/2"	3/4"	1"	1 1/4"	1 1/2"	2"
d	15	20	25	32	38	49
L	75	80	90	110	120	140
H	55	65	70	80	90	100
W	105	115	120	145	165	170
重量Weight						

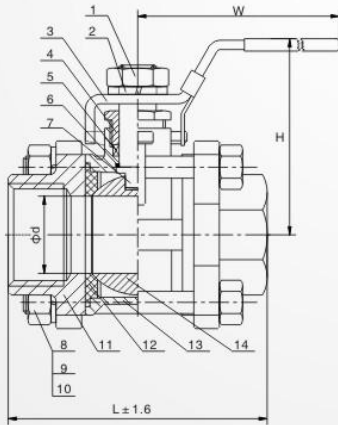

3PC碳钢球阀
3PC WCB thread ball valve



标准规范 Applicable Standards	
设计制造 Design	DIN3357
结构长度 FACE to FACE	DIN3202-M3
连接螺纹 End Threaded	DIN259/DIN2999
试验 Testing	DIN3230/EN12266

序号NO.	零件名称PART NAME	材料MATERIAL
1	螺母 Nut	304/316
2	弹垫 Spring Washer	304/316
3	手柄 Handle	304/316
4	填料压盖 Gland	304/316
5	填料 Packing	PTFE
6	止推垫片 Thrust Gasket	PTFE
7	阀杆 Stem	304/316
8	螺母 Nut	304/316
9	螺栓 Bolt	304/316
10	弹垫 Spring Washer	304/316
11	阀盖 Bonnet	WCB/CF8/CF8M
12	阀座 Seat	PTFE
13	阀体 Body	WCB/CF8/CF8M
14	球体 Ball	304/316

	1/2"	3/4"	1"	1 1/4"	1 1/2"	2"
d	15	20	25	32	38	49
L	75	80	90	110	120	140
H	55	65	70	80	90	100
W	105	115	120	145	165	170
重量Weight						

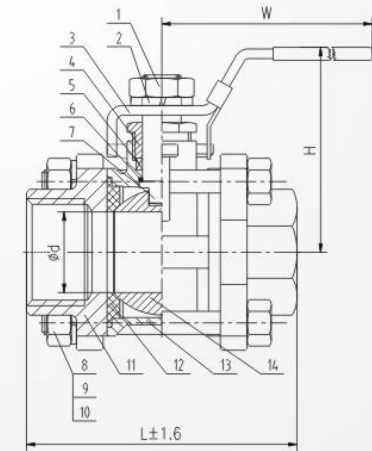

3PC德标法兰高平台球阀PN40
3PC DIN high platform flange valve PN40

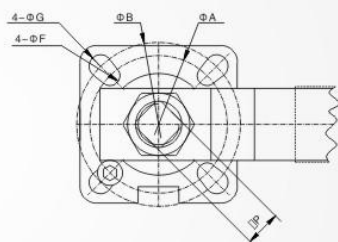
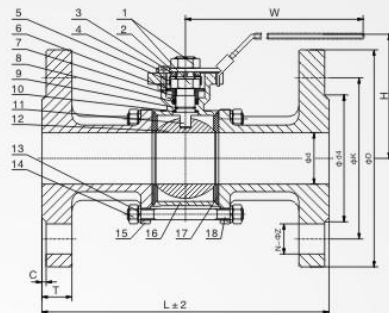

标准规范 Applicable Standards	
设计制造 Design	DIN3357
平台 Actuated Connecting	ISO5211
结构长度 FACE to FACE	DIN3202-F1
连接法兰 End Flange	DIN2633/EN1092-1
试验 Testing	DIN3230/EN12266

序号NO.	零件名称PART NAME	材料MATERIAL
1	螺母 Nut	304/316
2	手柄 Handle	304/316
3	垫片 Washer	304/316
4	内六角螺钉 Hex Screws	304/316
5	防松盖 Anti Loosing Cap	304/316
6	碟形弹簧 Disc Spring	304/316
7	填料压盖 Gland	304/316
8	填料 Packing	PTFE
9	O型圈 O-Rings	Viton
10	止推垫片 Thrust Gasket	PTFE
11	阀杆 Stem	304/316
12	球体 Ball	304/316
13	弹垫 Spring Washer	304/316
14	螺母 Nut	304/316
15	阀盖 Bonnet	CF8/CF8M
16	阀体 Body	CF8/CF8M
17	阀座 Seat	PTFE
18	双头螺栓 Stud Bolt	304/316

	1/2"	3/4"	1"	1 1/4"	1 1/2"	2"	2 1/2"	3"	4"
d	15	20	25	32	38	49	65	80	100
L	130	150	160	180	200	230	290	310	350
T	16	18	18	18	18	20	22	24	24
C	2	2	2	2	3	3	3	3	3
D	95	105	115	140	150	165	185	200	235
K	65	75	85	100	110	125	145	160	190
d4	46	56	65	76	84	99	118	132	156
N-Z	4-14	4-14	4-14	4-18	4-18	4-18	8-18	8-18	8-22
H	70	70	85	90	110	125	145	160	190
W	125	125	155	155	185	185	260	260	300
A	36	36	42	42	50	50	70	70	70
B	42	42	50	50	70	70	102	102	102
F	5.5	5.5	6	6	7	7	9	9	9
G	6	6	7	7	9	9	11	11	11
P	9	9	11	11	14	14	14	17	19
重量Weight									

3通高平台内螺纹球阀
3 way High platform of thread ball valve

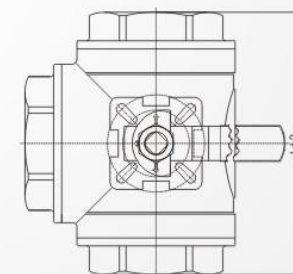
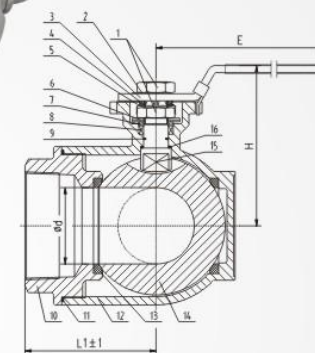

标准规范 Applicable Standards	
设计制造 Design	GB12237
平台 Actuated Connecting	ISO5211
结构长度 FACE to FACE	GB12221
连接螺纹 End Threaded	ISO7/1
试验 Testing	JB9092

序号NO.	零件名称PART NAME	材料MATERIAL
1	螺母 Nut	304/316
2	指示牌 Indicator	AL
3	手柄 Handle	304/316
4	垫片 Washer	304/316
5	防松盖 Anti Loosing Cap	304/316
6	碟形弹簧 Disc Spring	304/316
7	填料压盖 Gland	304/316
8	填料 Packing	PTFE
9	O型圈 O-Rings	Viton
10	阀盖 Bonnet	CF8/CF8M
11	密封垫 Gasket	PTFE
12	阀体 Body	CF8/CF8M
13	阀座 Seat	PTFE
14	球体 Ball	304/316
15	阀杆 Stem	304/316
16	止推垫片 Thrust Gasket	PTFE

	1/4"	3/8"	1/2"	3/4"	1"	1 1/4"	1 1/2"	2"	1 1/2"	3"
d	11	11	12	15	18	25	32	38	49	65
L	72	72	72	82	90	128	137	154	200	236
L1	36	36	36	41	45	64	68.5	77	100	118
H	65	65	65	70	80	90	110	115	140	155
W	125	125	125	125	155	155	185	185	260	260
A	36	36	36	36	42	42	50	50	70	70
B	42	42	42	42	50	50	70	70	102	102
F	5.5	5.5	5.5	5.5	6	6	7	7	9	9
G	6	6	6	6	7	7	9	9	11	11
P	9	9	9	9	11	11	14	14	17	17
重量Weight										

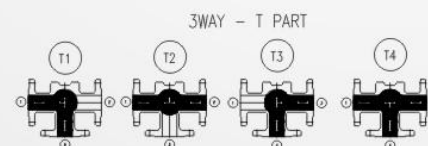

内螺纹闸阀
Thread gate valve



标准规范 Applicable Standards	
设计制造 Design	GB12224
结构长度 FACE to FACE	GB12221
连接螺纹 End Threaded	ISO7/1
试验 Testing	JB9092

序号NO.	零件名称PART NAME	材料MATERIAL
1	阀体 Body	CF8/CF8M
2	阀瓣 Disc	CF8/CF8M
3	密封垫 Gasket	PTFE
4	阀杆 Stem	304/316
5	阀盖 Bonnet	CF8/CF8M
6	止推垫片 Thrust Gasket	PTFE
7	填料 Packing	PTFE
8	填料压盖 Gland	304/316
9	螺母 Nut	304/316
10	手轮 Hand Wheel	304/316
11	铭牌 Nameplate	304/316
12	螺母 Nut	304/316
13	卡簧 Jump Ring	304/316

	1/2"	3/4"	1"	1 1/4"	1 1/2"	2"
d	15	19	24	30	38	48
L	54	60	63	71	78	88
H	95	105	115	130	145	160
W	65	65	71	77	96	96
重量Weight						

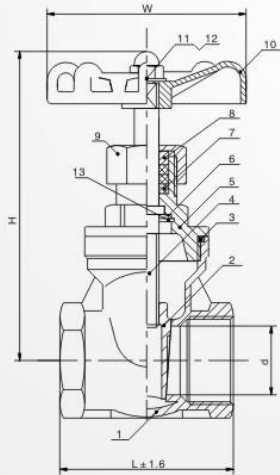

内螺纹截止阀
Thread globe valve



标准规范 Applicable Standards	
设计制造 Design	GB12224
结构长度 FACE to FACE	GB12221
连接螺纹 End Threaded	ISO7/1
试验 Testing	JB9092

序号NO.	零件名称PART NAME	材料MATERIAL
1	阀体 Body	CF8/CF8M
2	阀瓣 Disc	CF8/CF8M
3	阀杆 Stem	304/316
4	密封垫 Gasket	PTFE
5	阀盖 Bonnet	CF8/CF8M
6	填料 Packing	PTFE
7	填料压盖 Gland	304/316
8	螺母 Nut	304/316
9	手轮 Hand Wheel	304/316
10	铭牌 Nameplate	304/316
11	螺母 Nut	304/316

	1/2"	3/4"	1"	1 1/4"	1 1/2"	2"
d	15	20	25	32	40	50
L	59	69	79	89	104	119
H	90	95	105	125	135	145
W	65	65	73	76	98	98
重量Weight						

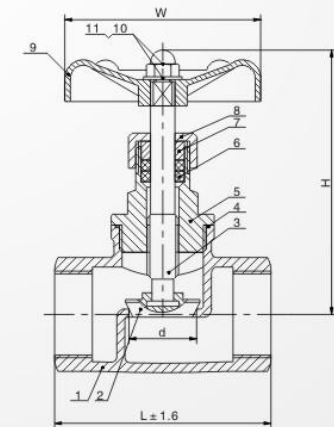

Y型过滤器
Y Type Strainer



标准规范 Applicable Standards	
设计制造 Design	GB12224
结构长度 FACE to FACE	GB12221
连接螺纹 End Threaded	ISO7/1
试验 Testing	JB9092

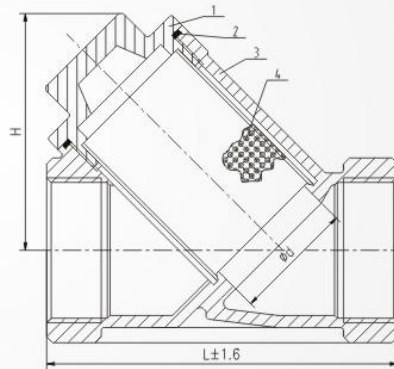

序号NO.	零件名称PART NAME	材料MATERIAL
1	阀盖 Bonnet	CF8/CF8M
2	密封垫 Gasket	PTFE
3	阀体 Body	CF8/CF8M
4	滤网 Screen	304/316

	1/4"	3/8"	1/2"	3/4"	1"	1 1/4"	1 1/2"	2"	2 1/2"	3"	4"
d	15	15	15	20	25	32	38	49	62	75	97
L	64.5	64.5	64.5	79.5	88	104	117.5	134	166	197	240
H	50	50	50	60	65	75	85	95	120	155	169
重量Weight											

旋启式内螺纹止回阀
Swing thread check valve



标准规范 Applicable Standards	
设计制造 Design	GB12224
结构长度 FACE to FACE	GB12221
连接螺纹 End Threaded	ISO7/1
试验 Testing	JB9092

	1/2"	3/4"	1"	1 1/4"	1 1/2"	2"
d	15	20	25	31	37	47
L	64	78	88	101	117	134
H	40	45	50	60	65	75
重量Weight						

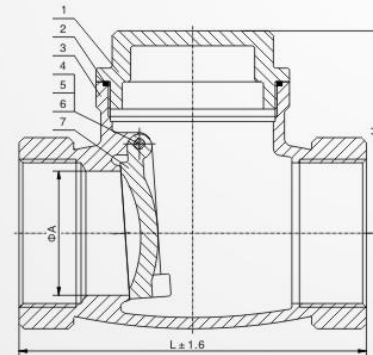

序号NO.	零件名称PART NAME	材料MATERIAL
1	阀盖 Bonnet	CF8/CF8M
2	密封垫 Gasket	PTFE
3	阀体 Body	CF8/CF8M
4	销 Pin	304/316
5	螺母 Nut	304/316
6	密封垫 Gasket	PTFE
7	阀瓣 Disc	CF8/CF8M

对夹止回阀PN25
Wafer check valve PN25

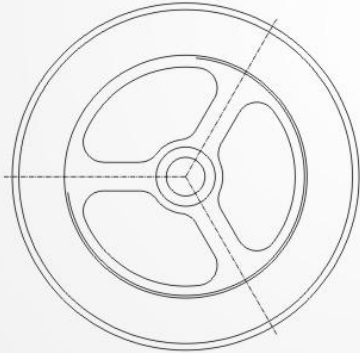
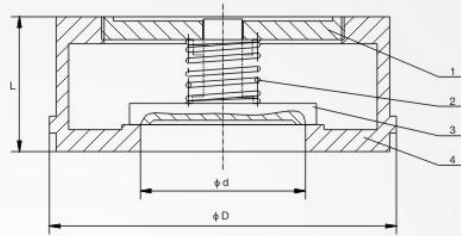

标准规范 Applicable Standards	
设计制造 Design	GB12224
结构长度 FACE to FACE	GB12221
试验 Testing	JB9092

序号NO.	零件名称PART NAME	材料MATERIAL
1	阀盖 Bonnet	CF8/CF8M
2	弹簧 Spring	304/316
3	阀瓣 Disc	CF8/CF8M
4	阀体 Body	CF8/CF8M

	1/2"	3/4"	1"	1 1/4"	1 1/2"	2"	2 1/2"	3"	4"	5"	6"	8"
d	15	20	25	32	38	49	60	70	91	117	137	190
L	25	28	28	30	35	40	49	57	68	78	95	110
D	48	58	68.5	79	87	103	124	138	161	185	207	272
重量Weight												

Y型止回阀
Y type check valve

标准规范 Applicable Standards	
设计制造 Design	GB12224
结构长度 FACE to FACE	GB12221
连接螺纹 End Threaded	ISO7/1
试验 Testing	JB9092

	1/2"	3/4"	1"	1 1/4"	1 1/2"	2"	2 1/2"	3"	4"
d	15	20	25	32	40	49	62	75	97
L	64.5	79.5	88	104	117.5	134	166	197	240
H	48	55	65	75	80	95	120	155	169
重量Weight									

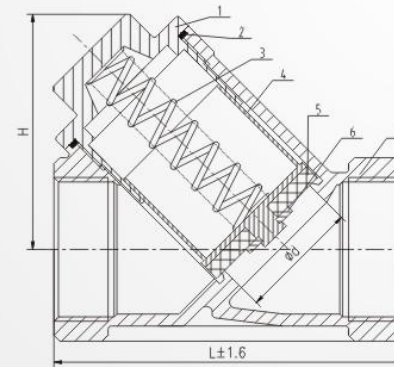

序号NO.	零件名称PART NAME	材料MATERIAL
1	阀盖 Bonnet	WCB/CF8/CF8M
2	密封垫 Gasket	PTFE
3	弹簧 Spring	304/316
4	阀芯 Valve core	WCB/CF8/CF8M
5	阀座 Seat	PTFE
6	卡簧 Circlip	304/316
7	阀体 Body	WCB/CF8/CF8M

3PC止回阀
3PC check valve



标准规范 Applicable Standards	
设计制造 Design	GB12224
结构长度 FACE to FACE	GB12221
连接螺纹 End Threaded	ISO7/1
试验 Testing	JB9092

序号NO.	零件名称PART NAME	材料MATERIAL
1	阀盖 Bonnet	WCB/CF8/CF8M
2	螺栓 Bolt	304/316
3	密封垫 Gasket	PTFE
4	阀瓣 Disc	WCB/CF8/CF8M
5	阀体 Body	WCB/CF8/CF8M
6	弹簧 Spring	304/316
7	弹簧垫圈 Spring Washer	304/316
8	螺母 Nut	304/316

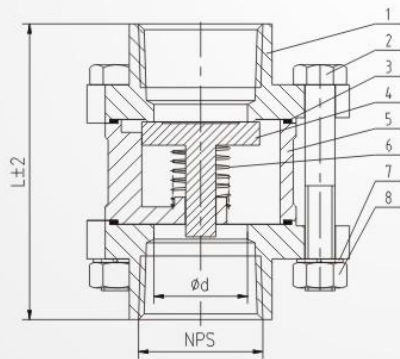

	1/2"	3/4"	1"	1 1/4"	1 1/2"	2"	2 1/2"
d	15	20	25	32	40	49	62
L	60	70	79	93	101	117	122
重量Weight							

CL150~600/10~40K锻钢法兰闸阀
The forged steel flange gate valve

规格 specs 英制 british system	公制 metric system	压力 等级 Pressure Class	H(开)		W		D3	D2	D1	T	f	N-Φ	重量(kg/Weight)			
			缩径 RP	全径 FP	缩径 RP	全径 FP							缩径 RP	全径 FP		
1/2	15	150	108	166	169	100	100	35	60.5	89	11.5	1.6	4-16	4.5	5	
		300	140							66.5	95	14.5	1.6	4-16	4.8	5.2
		600	165							66.5	95	14.5	6.4	4-16	5.9	5.9
3/4	20	150	117	169	193	100	125	43	70	98	13	1.6	4-16	5.2	6.1	
		300	152							82.5	118	16	1.6	4-19	6.2	6.3
		600	190							82.5	118	16	6.4	4-19	7.4	7.5
1	25	150	127	193	230	125	160	51	79.5	108	14.5	1.6	4-16	8.2	8.4	
		300	165							89	124	17.5	1.6	4-19	9.3	8.6
		600	216							89	124	17.5	6.4	4-19	10.4	10.2
1 1/4	32	150	140						89	118	16	1.6	4-16	11.5	14.3	
		300	178	230	246	160	160	63.5	98.5	133	19.5	1.6	4-19	14	14.5	
		600	229							98.5	133	21	6.4	4-19	16.2	16.7
1 1/2	40	150	165						98.5	127	17.5	1.6	4-16	12.5	15.4	
		300	190	246	283	160	180	73	114.5	156	21	1.6	4-22.5	15.5	15.6	
		600	241							114.5	156	22.5	6.4	4-22.5	17.5	17.4
2	50	150	178	263	330	180	200	92	120.5	152	19.5	1.6	4-19	20.3	22.7	
		300	216							127	165	22.5	1.6	8-19	23.4	22.8
		600	292							127	165	25.5	6.4	8-19	28.3	28.7



规格 specs 英制 british system	公制 metric system	压力 等级 Pressure Class	H(开)		W		D3	D2	D1	T	f	N-Φ	重量(kg/Weight)				
			缩径 RP	全径 FP	缩径 RP	全径 FP							缩径 RP	全径 FP			
1/2	15	10K	108	166	169	100	100	52	70	95	12	1	4-15	4.8	5		
		20K	140							70	95	14	1	4-15	5.2	5.2	
		40K	165							55	80	115	20	1	4-19	6.4	6.5
3/4	20	10K	117	169	193	100	125	58	75	100	14	1	4-15	5.4	5.5		
		20K	152							75	100	16	1	4-15	6.5	6.6	
		40K	190							60	85	120	20	1	4-19	7.8	8
1	25	10K	127						90	125	14	1	4-19	8.6	8.8		
		20K	165	193	230	125	160	70	90	125	16	1	4-19	9.7	10.8		
		40K	216							70	95	130	22	1	4-19	11.5	12.2
1 1/4	32	10K	140						100	135	16	2	4-19	13.2	14.3		
		20K	178	230	246	160	160	80	100	135	18	2	4-19	14.5	14.5		
		40K	229							80	105	140	24	2	4-19	17.8	13
1 1/2	40	10K	165						105	140	16	2	4-19	14.8	15.06		
		20K	190	246	283	160	180	85	105	140	18	2	4-19	15.9	16.2		
		40K	241							90	120	160	24	2	4-23	18.8	19
2	50	10K	178	263	330	180	200	100	120	155	16	2	4-19	21	22.7		
		20K	216							100	120	155	18	2	8-19	25	26
		40K	292							105	130	165	26	2	8-19	29.5	30

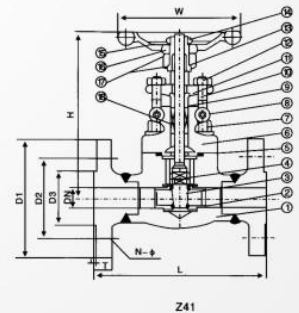

注意：客户需要的其他材质也可采用。密封材料配对由客户指定内件代号决定。
CS-碳钢 Carbon Steel; AS-合金钢 Alloy Steel; SS-不锈钢 Stainless Steel;
Note: Availability of other materials to customers' requests. The matched material of sealing face is subject to the code of trim designated by customers.

CL150~600锻钢对焊闸阀
The forged steel Butt-welding gate valve

规格 specs		L			W	H(开)	重量(kg) Weight		
英制 british system	公制 metric system	150磅级	300磅级	600磅级			150磅级	300磅级	600磅级
3/8	10	102	-	-	2.8	151	2.8	-	-
1/2	15	108	140	165	2.8	151	2.8	3.5	4.5
3/4	20	117	152	191	3.3	158	3.3	4.4	5.1
1	25	127	165	216	5.4	190	5.4	6.8	8.2
1 1/4	32	138	178	229	7.1	219	7.1	8.1	10.5
1 1/2	40	165	191	241	8.2	246	8.2	9.2	12.4
2	50	178	216	292	12.5	283	12.5	15.4	20.1

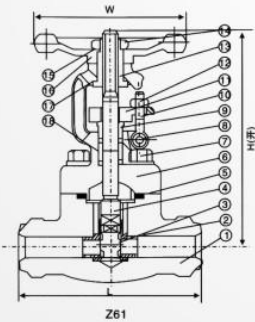

序号 NO	零件名称 Name of Part	CS to ASTM Type A105N	AS to ASTM Type F22	SS to ASTM	
				Type F304(L)	Type F316(L)
1	阀体 Body	A105N	A182 F22	A182 F304(L)	A182 F316(L)
2	阀座 Seat	A276 420	A276 304	A276 304(L)	A276 316(L)
3	闸板 Gate Disc	A182 F430	A182 F304	A182 F304(L)	A182 F316(L)
4	闸杆 Stem	A182 F6a	A182 F22	A182 F304(L)	A182 F316(L)
5	垫片 Gasket	304夹柔性石墨 304 Flexible Graphite		316夹PTFE	
6	阀盖 Bonnet	A105N	A182 F22	A182 F304(L)	A182 F316(L)
7	阀盖螺栓 Bonnet Bolt	A193 B7	A193 B16	A193 B8	A193 B8M
8	圆柱销 Straight Pin	A276 420		A182 F304	
9	填料压套 Packing Pressure Sleeve	A276 410		A182 F304(L)	A182 F316(L)
10	活节螺栓 Eyelet Bolt	A193 B7	A193 B16	A193 B8	A193 B8M
11	填料压板 Packing Pressure Plate	WCB	A182 F11	A182 F304(L)	A182 F316(L)
12	螺母 Nut	A194 2H	A1944	A194 8	A194 8M
13	闸杆螺母 Stem Nut	A276 420			
14	锁紧螺母 Locknut	A194 2H	A1944	A194 8	A194 8M
15	铭牌 Nameplate	SS			
16	手轮 Handwheel	HT200			
17	润滑垫片 Lubricating Gasket	A473 431			
18	填料 Packing	柔性石墨+碳纤维 Flexible Graphite+Carbon Fiber		PTFE	
适用介质 Applicable Medium	水、蒸汽、油品等 Water, steam and oil product etc.		水、蒸汽、油品等 Water, steam and oil product etc.		硝酸、醋酸等 Nitric acid and acetic acid etc.
适用温度 Applicable Temperature	-29°C~425°C		-29°C~550°C		-29°C~200°C

注意：客户需要的其他材质也可采用。密封面材料配对由客户指定内件代号决定。
CS=碳钢 Carbon Steel; AS=合金钢 Alloy Steel; SS=不锈钢 Stainless Steel.
Note: Availability of other materials to customers' requests. The matched material of sealing face is subject to the code of trim designated by customers.

CL150~800锻钢内螺纹、承插焊闸阀
The forged steel NPT(S.W) gate valve

规格 specs		S				T				W	H (开)	重量(kg) Weight			
英制 british system	公制 metric system	ANSI		JIS		ANSI 牙型60°		JIS, JSC, BC 牙型55°				≈	≈	缩径 RP	全径 FP
3/8	10	17.6	17.9	79	3/8	3/8	3/8	100	166	2.2	2.2				
1/2	3/8	15	10	21.8	17.6	22.2	17.9	79	1/2	3/8	3/8	100	166	2.2	2.2
3/4	1/2	20	15	27.1	21.8	27.7	22.2	92	3/4	1/2	3/4	100	169	2.2	2.2
1	3/4	25	20	33.8	27.1	34.5	27.7	111	1	3/4	1	125	193	4.3	4.3
1 1/4	1	32	25	42.6	33.8	43.2	34.5	120	1 1/4	1	1 1/4	160	236	5.9	5.9
1 1/2	1 1/4	40	32	48.7	42.6	49.1	43.2	120	1 1/2	1 1/4	1 1/2	160	246	6.9	6.9
2	1 1/2	50	40	61.1	48.7	61.1	49.1	140	2	1 1/2	2	180	283	11.1	11.1
2	50	61.1	61.1	178	2	2	200	330	15.2						

序号 NO	零件名称 Name of Part	CS to ASTM Type A105N	AS to ASTM Type F22	SS to ASTM	
				Type F304(L)	Type F316(L)
1	阀体 Body	A105N	A182 F22	A182 F304(L)	A182 F316(L)
2	阀座 Seat	A276 420	A276 304	A276 304(L)	A276 316(L)
3	闸板 Gate Disc	A182 F430	A182 F304	A182 F304(L)	A182 F316(L)
4	闸杆 Stem	A182 F6a	A182 F22	A182 F304(L)	A182 F316(L)
5	垫片 Gasket	304夹柔性石墨 304 Flexible Graphite		316夹PTFE	
6	阀盖 Bonnet	A105N	A182 F22	A182 F304(L)	A182 F316(L)
7	阀盖螺栓 Bonnet Bolt	A193 B7	A193 B16	A193 B8	A193 B8M
8	圆柱销 Straight Pin	A276 420		A182 F304	
9	填料压套 Packing Pressure Sleeve	A276 410		A182 F304(L)	A182 F316(L)
10	活节螺栓 Eyelet Bolt	A193 B7	A193 B16	A193 B8	A193 B8M
11	填料压板 Packing Pressure Plate	WCB	A182 F11	A182 F304(L)	A182 F316(L)
12	螺母 Nut	A194 2H	A1944	A194 8	A194 8M
13	闸杆螺母 Stem Nut	A276 420			
14	锁紧螺母 Locknut	A194 2H	A1944	A194 8	A194 8M
15	铭牌 Nameplate	SS			
16	手轮 Handwheel	HT200			
17	润滑垫片 Lubricating Gasket	A473 431			
18	填料 Packing	柔性石墨+碳纤维 Flexible Graphite+Carbon Fiber		PTFE	
适用介质 Applicable Medium	水、蒸汽、油品等 Water, steam and oil product etc.		水、蒸汽、油品等 Water, steam and oil product etc.		硝酸、醋酸等 Nitric acid and acetic acid etc.
适用温度 Applicable Temperature	-29°C~425°C		-29°C~550°C		-29°C~200°C

注意：客户需要的其他材质也可采用。密封面材料配对由客户指定内件代号决定。
CS=碳钢 Carbon Steel; AS=合金钢 Alloy Steel; SS=不锈钢 Stainless Steel.
Note: Availability of other materials to customers' requests. The matched material of sealing face is subject to the code of trim designated by customers.

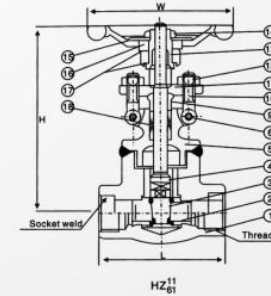
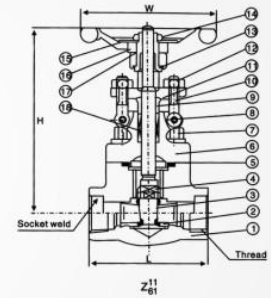



CL150~600/10~40K锻钢法兰截止阀
The forged steel flange globe valve

规格 specs		压力 磅级 Metric Class	L	H(开)		W		D3	D2	D1	T	f	N-Φ	重量(kg/Weight)						
英制 british system	公制 metric system			缩径 RP	全径 FP	缩径 RP	全径 FP							缩径 RP	全径 FP					
1/2	15	150	108	158	163	100	100	35	60.5	89	11.5	1.6	4-16	4.5	6.9					
		300	152											66.5	95	14.5	1.6	4-16	4.8	7.7
		600	165											66.5	95	14.5	6.4	4-16	5.6	7.8
3/4	20	150	117	163	193	100	125	43	70	99	13	1.6	4-16	6.9	9.8					
		300	178											82.5	118	16	1.6	4-20	7.7	11.3
		600	190											82.5	118	16	6.4	4-20	7.8	12.5
1	25	150	127	193	250	125	160	51	79.5	108	14.5	1.6	4-16	9.8	13.5					
		300	203											89	124	17.5	1.6	4-20	11	16.8
		600	216											89	124	17.5	6.4	4-20	12.5	17.5
1 1/4	32	150	140	250	250	160	160	63.5	98.5	133	19.5	1.6	4-20	16.8	21.2					
		300	216											98.5	133	21	6.4	4-20	17	23.5
		600	229											98.5	127	17.5	1.6	4-16	19.5	28.5
1 1/2	40	150	165	250	291	160	180	73	114.5	156	21	1.6	4-22	21.2	32.6					
		300	229											114.5	156	22.5	6.4	4-22	23.5	38.5
		600	241											120.5	152	19.5	1.6	4-20	28	30.3
2	50	150	178	291	312	180	200	92	127	165	22.5	1.6	8-20	32.6	35					
		300	267											127	165	25.5	6.4	8-20	38.8	42.2
		600	292																	



规格 specs		压力 磅级 Metric Class	L	H(开)		W		D3	D2	D1	T	f	N-Φ	重量(kg/Weight)						
英制 british system	公制 metric system			缩径 RP	全径 FP	缩径 RP	全径 FP							缩径 RP	全径 FP					
1/2	15	10K	108	158	163	100	100	52	70	95	12	1	4-15	4.8	7.2					
		20K	152											70	95	14	4-15	5.2	8.0	
		40K	165											55	80	115	20	4-19	7.4	9.8
3/4	20	10K	117	163	193	100	125	58	75	100	16	1	4-15	8.0	12.0					
		20K	178											60	85	120	20	4-19	9.8	13.3
		40K	190											90	125	14	4-19	10.2	14.2	
1	25	10K	127	193	250	125	160	70	90	125	16	1	4-19	12.0	15.7					
		20K	165											70	95	130	22	4-19	13.3	18.5
		40K	216											100	135	16	4-19	14.2	20.0	
1 1/4	32	10K	140	250	250	160	160	80	100	135	18	2	4-19	15.7	23.0					
		20K	216											80	105	140	24	4-19	18.5	27.3
		40K	229											80	105	140	16	4-19	20.0	29.5
1 1/2	40	10K	165	250	291	160	180	85	105	140	16	2	4-19	23.0	35.4					
		20K	229											90	120	160	24	4-23	27.3	38.6
		40K	241											120	155	16	4-19	29.5	30.3	
2	50	10K	178	291	312	180	200	100	120	155	18	2	8-19	35.4	36.6					
		20K	267											105	130	165	26	8-19	38.6	40.0
		40K	292																	

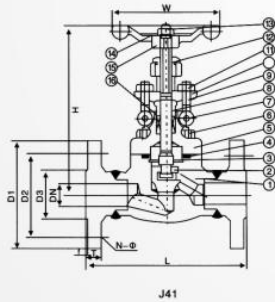

J41

注意：客户需要的其他材质也可采用。密封面材料配对由客户指定内件代号决定。
CS=碳钢 Carbon Steel, AS=合金钢 Alloy Steel, SS=不锈钢 Stainless Steel.
Note: Availability of other materials to customers' requests. The matched material of sealing face is subject to the code of trim designated by customers.



CL150~600锻钢对焊截止阀
The forged steel Butt-welding globe valve

规格 specs		L			W	H(开)	重量(kg) Weight		
英制 british system	公制 metric system	150磅级	300磅级	600磅级			150磅级	300磅级	600磅级
1/2	15	108	152	165	100	158	2.3	2.8	3.4
3/4	20	117	178	190	100	192	3.6	4.0	4.7
1	25	127	203	216	125	252	7.8	8.5	9.2
1 1/4	32	140	216	229	160	252	8.2	9.2	10.5
1 1/2	40	165	229	241	160	289	12.0	12.6	13.3
2	50	203	267	292	180	330	15.0	16.8	18.9

序号 NO	零件名称 Name of Part	CS to ASTM	AS to ASTM	SS to ASTM	
		Type A105N	Type F22	Type F304(L)	Type F316(L)
1	阀体 Body	A105N	A182 F22	A182 F304(L)	A182 F316(L)
2	阀座 Seat	A276 420	A276 304	A276 304(L)	A276 316(L)
3	阀杆 Stem	A182 F6a	A182 F304	A182 F304(L)	A182 F316(L)
4	密封座 Sealing Seat	A105N	A182 F304	A182 F304(L)	A182 F316(L)
5	密封座 Sealing Seat	316	A182 F304	A182 F304(L)	F316(L)
6	阀盖 Bonnet	A105N	A182 F22	A182 F304(L)	A182 F316(L)
7	圆柱销 Straight Pin	A276 F420		A182 F304	
8	垫圈 Gasket	A105N	A182 F22	A182 F304(L)	A182 F316(L)
9	提升螺母 Lifting Nut	A194 2H	A194 4	A194 B8	A194 B8M
10	填料 Packing	柔性石墨+304丝 Flexible Graphite+304		PTFE	
11	填料压套 Packing Pressure Sleeve	A276 F420		A182 F304	
12	填料压板 Packing Pressure Plate	A105		A182 F304	
13	活节螺栓 Eyelet Bolt	A193 B7	A193 B16	A193 B8	A193 B8M
14	螺母 Nut	A194 2H	A194 4	A194 8	A194 8M
15	阀杆螺母 Stem Nut	A276-420			
16	手轮 Handwheel	A197			
17	铭牌 Nameplate	SS			
适用介质 Applicable Medium		水、蒸汽、油品等 Water, steam and oil product etc.		硝酸、醋酸等 Nitric acid and acetic acid etc.	
适用温度 Applicable Temperature		-29℃~425℃		-29℃~200℃	

注意：客户需要的其他材质也可采用。密封面材料配对由客户指定内件代号决定。
CS=碳钢 Carbon Steel, AS=合金钢 Alloy Steel, SS=不锈钢 Stainless Steel.
Note: Availability of other materials to customers' requests. The matched material of sealing face is subject to the code of trim designated by customers.

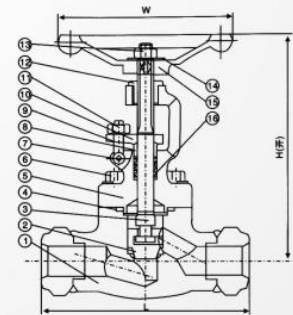

CL150~800锻钢内螺纹、承插焊截止阀
The forged steel NPT(S.W) globe valve

锻钢阀系列
Forged Valve Series

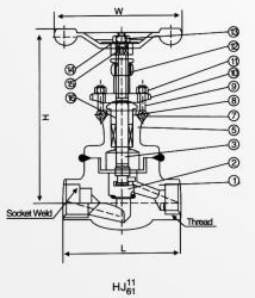
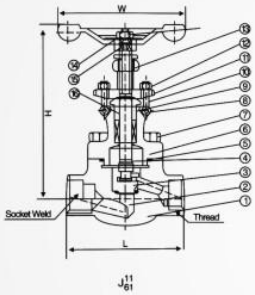

规格 specs		S				T				W	H (开)	重量(kg) Weight				
英制 british system	公制 metric system	ANSI		JIS		ANSI 牙型60°		JIS,JSC,BC 牙型55°				~	~			
缩径 RP	全径 FP	缩径 RP	全径 FP	缩径 RP	全径 FP	缩径 RP	全径 FP	缩径 RP	全径 FP	缩径 RP	全径 FP					
3/8	10	17.6	17.9	79	3/8	3/8	100	153	1.9							
1/2	3/8	15	10	21.8	17.6	22.2	17.9	79	1/2	3/8	1/2	3/8	100	158	1.9	2.1
3/4	1/2	20	15	27.1	21.8	27.7	22.2	92	3/4	1/2	3/4	1/2	100	192	2.1	2.3
1	3/4	25	20	33.8	27.1	34.5	27.7	111	1	3/4	1	3/4	125	252	3.3	3.6
1 1/4	1	32	25	42.6	33.8	43.2	34.5	120	1 1/4	1	1 1/4	1	160	252	7.5	7.8
1 1/2	1 1/4	40	32	48.7	42.6	49.1	43.2	152	1 1/2	1 1/4	1 1/2	1 1/4	160	289	7.5	8.2
2	1 1/2	50	40	61.1	48.7	61.1	49.1	172	2	1 1/2	2	1 1/2	180	330	11.4	12.0
2	2	50	50	61.1	61.1	200	2	2	240	370	14.6	15.0				

序号 NO	零件名称 Name of Part	CS to ASTM Type A105N	AS to ASTM Type F22	SS to ASTM	
				Type F304(L)	Type F316(L)
1	阀体 Body	A105N	A182 F22	A182 F304(L)	A182 F316(L)
2	阀瓣 Disc	A182 F430	A182 F304	A182 F304(L)	A182 F316(L)
3	阀杆 Stem	A182 F6a	A182 F22	A182 F304(L)	A182 F316(L)
4	垫片 Gasket	304夹柔性石墨 304 Flexible Graphite		316夹PTFE	
5	阀盖 Bonnet	A105N	A182 F22	A182 F304(L)	A182 F316(L)
6	阀盖/螺栓 Bonnet Bolt	A193 B7	A193 B16	A193 B8	A193 B8M
7	圆柱销 Straight Pin	A276 420		A182 F304	
8	填料压套 Packing Pressure Sleeve	A276 410		A182 F304(L)	A182 F316(L)
9	活节螺栓 Eyelet Bolt	A193 B7	A193 B16	A193 B8	A193 B8M
10	填料压板 Packing Pressure Plate	A105	A182 F11	A182 F304(L)	A182 F316(L)
11/13	螺母 Nut	A276 420			
12	阀杆螺母 Stem Nut	A194 2H	A1944	A194 8	A194 8M
14	铭牌 Nameplate	SS			
15	手轮 Handwheel	A197			
16	填料 Packing	柔性石墨+碳素纤维 Flexible Graphite+Carbon Fiber		PTFE	
适用介质 Applicable Medium		水、蒸汽、油品等 Water, steam and oil product etc.		硝酸、醋酸等 Nitric acid and acetic acid etc.	
适用温度 Applicable Temperature		-29°C~425°C		-29°C~550°C	

注意：客户需要的其他材质也可采用。密封面材料配对由客户指定内件代号决定。
CS=碳钢 Carbon Steel; AS=合金钢 Alloy Steel; SS=不锈钢 Stainless Steel;
Note: Availability of other materials to customers' requests. The matched material of sealing face is subject to the code of trim designated by customers.

CL150~600锻钢法兰止回阀
The forged steel flange check valve

锻钢阀系列
Forged Valve Series

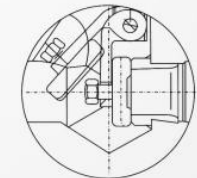
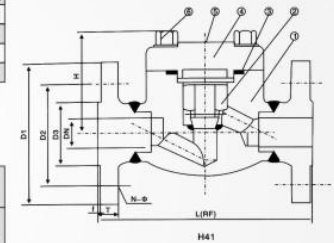

规格 specs	英制 british system	公制 metric system	压力 磅级 Pressure Class	H(开)		D3	D2	D1	T	f	N-Φ	重量(kg) Weight	
				缩径 RP	全径 FP							缩径 RP	全径 FP
1/2	15	150	105	61	61	35	60.5	89	11.5	1.6	4-16	2.56	3.37
		300	152				66.5	95	14.5	1.6	4-16	2.73	3.65
		600	165				66.5	95	14.5	6.4	4-16	3.00	4.00
3/4	20	150	117	61	78	43	70	99	13	1.6	4-16	3.37	4.37
		300	178				82.5	118	16	1.6	4-19	3.65	4.74
		600	190				82.5	118	16	6.4	4-19	4.00	5.83
1	25	150	127	78	84	51	79.5	108	14.5	1.6	4-16	4.37	8.17
		300	203				89	124	17.5	1.6	4-19	4.74	8.17
		600	216				89	124	17.5	6.4	4-19	5.83	9.47
1 1/4	32	150	140	84	103	63.5	98.5	133	19.5	1.6	4-19	8.17	9.60
		300	216				98.5	133	21	6.4	4-19	9.47	10.10
		600	229				98.5	127	17.5	1.6	4-16	8.94	12.04
1 1/2	40	150	165	103	118	73	114.5	156	21	1.6	4-22.5	9.60	13.70
		300	229				114.5	156	22.5	6.4	4-22.5	10.10	15.61
		600	241				120.5	152	19.5	1.6	4-19	12.64	14.3
2	50	150	203	118	130	92	127	165	22.5	1.6	8-19	13.70	17.8
		300	267				127	165	25.5	6.4	8-19	15.61	24.6
		600	292										

序号 NO	零件名称 Name of Part	CS to ASTM Type A105N	AS to ASTM Type F22	SS to ASTM	
				Type F304(L)	Type F316(L)
1	阀体 Body	A105N	A182 F22	A182 F304(L)	A182 F316(L)
2	升降式阀瓣 Lift Disc	A276 420	A276 304	A276 304(L)	A276 316(L)
3	垫片 Gasket	304夹柔性石墨 304 Flexible Graphite		316夹PTFE	
4	阀盖 Bonnet	A105N	A182 F22	A182 F304(L)	A182 F316(L)
5	铭牌 Nameplate	SS			
6	螺栓 Bolt	A193 B7	A193 B16	A193 B8	A193 B8M
适用介质 Applicable Medium		水、蒸汽、油品等 Water, steam and oil product etc.		硝酸、醋酸等 Nitric acid and acetic acid etc.	
适用温度 Applicable Temperature		-29°C~425°C		-29°C~550°C	

注意：客户需要的其他材质也可采用。密封面材料配对由客户指定内件代号决定。
CS=碳钢 Carbon Steel; AS=合金钢 Alloy Steel; SS=不锈钢 Stainless Steel;
Note: Availability of other materials to customers' requests. The matched material of sealing face is subject to the code of trim designated by customers.

CL150~800锻钢内螺纹、承插焊升降式止回阀
The forged steel NPT(S.W) lift check valve

锻钢阀系列
Forged Valve Series

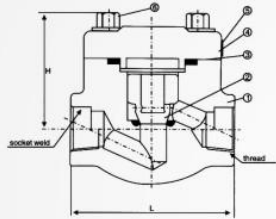

HH11

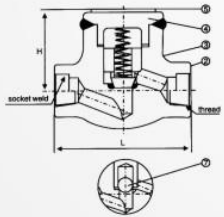

HH11

规格 specs		S		L	T			H(开)≈ 重量(kg) Weight
英制 british system	公制 metric system	ANSI	JIS		ANSI	ISO、BS	JIS	
1/2	15	21.8	22.2	79	1/2			1.4
3/4	20	27.1	27.7	92	3/4			1.5
1	25	33.8	34.5	111	1			3.1
1 1/4	32	42.6	43.2	120	1 1/4			3.9
1 1/2	40	48.7	49.1	152	1 1/2			5.6
2	50	61.1	61.1	172	2			8.9

序号 NO	零件名称 Name of Part	CS to ASTM Type A105N	AS to ASTM Type F22	SS to ASTM	
				Type F304(L)	Type F316(L)
1	阀体 Body	A105N	A182 F22	A182 F304(L)	A182 F316(L)
2	升降式阀瓣 Lift Disc	A276 420	A276 304	A276 304(L)	A276 316(L)
3	垫片 Gasket	304夹柔性石墨 304 Flexible Graphite		316夹PTFE	
4	阀盖 Bonnet	A105N	A182 F22	A182 F304(L)	A182 F316(L)
5	铭牌 Nameplate	SS			
6	螺栓 Bolt	A193 B7	A193 B16	A193 B8	A193 B8M
7	球 Ball	A182 F420	A182 F304	A182 F304	A182 F304
适用介质 Applicable Medium		水、蒸汽、油品等 Water, steam and oil product etc.	水、蒸汽、油品等 Water, steam and oil product etc.	硝酸、醋酸等 Nitric acid and acetic acid etc.	
适用温度 Applicable Temperature		-29℃~425℃	-29℃~550℃	-29℃~200℃	

注意：客户需求的材质也可采用。密封材料配对由客户指定内件代号决定。
CS=碳钢 Carbon Steel; AS=合金钢 Alloy Steel; SS=不锈钢 Stainless Steel.
Note: Availability of other materials to customers' requests. The matched material of sealing face is subject to the code of trim designated by customers.

CL800~1500锻钢内螺纹、承插焊旋启式止回阀
The forged steel NPT(S.W) swing check valve

锻钢阀系列
Forged Valve Series

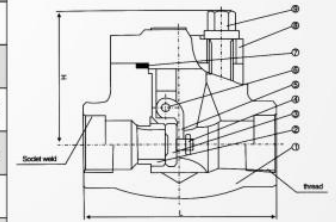

H14/64

规格 specs		S		L	T				H(开)		重量(kg) Weight	
英制 british system	公制 metric system	ANSI	JIS		ANSI ISO、BS NPT牙型60°	JIS RC或PT牙型55°	800Lb 900~	1500Lb	800Lb 900~	1500Lb		
1/2	15	21.8	22.2	79	92	1/2	1/2	61	79	1.1	3.1	
3/4	20	27.1	27.7	92	111	3/4	1/2	61	79	1.0	3.0	
1	25	33.8	34.5	111	120	1	3/4	78	79	1.9	3.6	
1 1/4	32	42.6	43.2	120	120	1 1/4	1	84	97	3.9	4.3	
1 1/2	40	48.7	49.1	152	140	1 1/2	1 1/4	101	105	4.5	6.1	
2	50	61.1	61.1	172	200	2	2	133	140	10.0	12.6	

序号 NO	零件名称 Name of Part	CS to ASTM Type A105N	AS to ASTM Type F22	SS to ASTM	
				Type F304(L)	Type F316(L)
1	阀体 Body	A105N	A182 F22	A182 F304(L)	A182 F316(L)
2	阀座 Seat	A276 420	A276 304	A276 304(L)	A276 316(L)
3	阀瓣 Disc	A276 410	F304	A182 F304(L)	F316(L)
4	螺母 Nut	A194 2H	A194 4	A194 8	A194 8M
5	摇臂 Rocking Arm	A105N	A182 F22	A182 F304(L)	A182 F316(L)
6	圆柱销 Straight Pin	A276 420	F304	A182 F304(L)	A182 F316(L)
7	垫片 Gasket	304夹柔性石墨 304 Flexible Graphite		316夹PTFE	
8	阀盖 Bonnet	A105N	A182 F22	A182 F304(L)	A182 F316(L)
9	螺栓 Bolt	A193 B7	A193 B16	A193 B8	A193 B8M
适用介质 Applicable Medium		水、蒸汽、油品等 Water, steam and oil product etc.	水、蒸汽、油品等 Water, steam and oil product etc.	硝酸、醋酸等 Nitric acid and acetic acid etc.	
适用温度 Applicable Temperature		-29℃~425℃	-29℃~550℃	-29℃~200℃	

注意：客户需求的材质也可采用。密封材料配对由客户指定内件代号决定。
CS=碳钢 Carbon Steel; AS=合金钢 Alloy Steel; SS=不锈钢 Stainless Steel.
Note: Availability of other materials to customers' requests. The matched material of sealing face is subject to the code of trim designated by customers.



浙江昌一阀门有限公司
ZHEJIANG CHANGYI VALVE CO.,LTD

www.changyivalve.com

铸件
Casting



www.changyivalve.com

浙江昌一阀门有限公司
ZHEJIANG CHANGYI VALVE CO.,LTD



铸件
Casting

